

SECTION 2: EXISTING

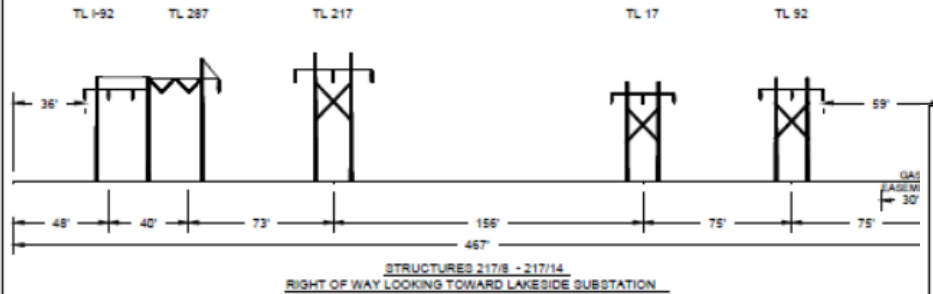

Example of proposed changes

Height range: 57' – 84'

SECTION 2: PROPOSED

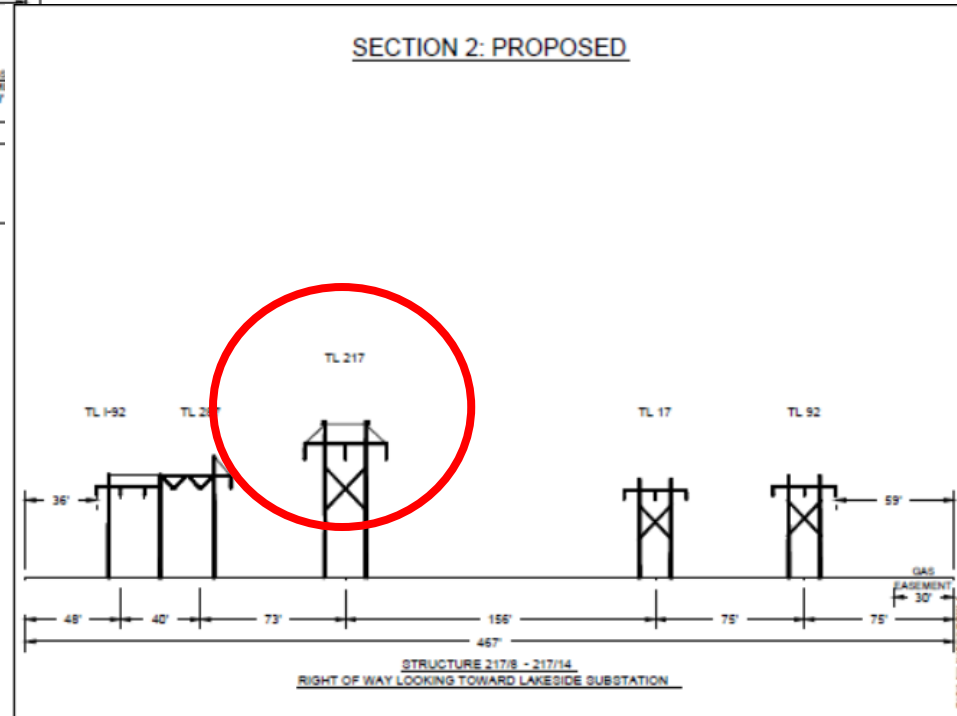

Proposed height range: 75' – 95'

*Subject to final engineering

SECTION 7: EXISTING

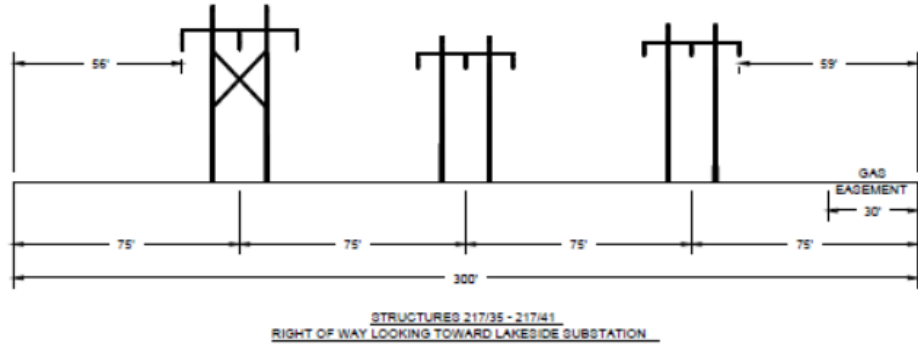

Height range: 52' – 61'

Example of proposed changes

SECTION 7: PROPOSED

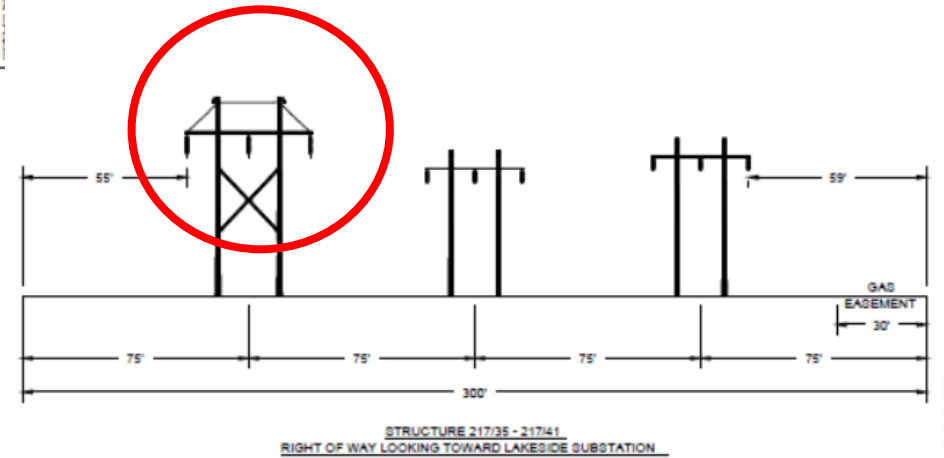

Proposed height range: 60' – 70'

*Subject to final engineering

SECTION 9: EXISTING

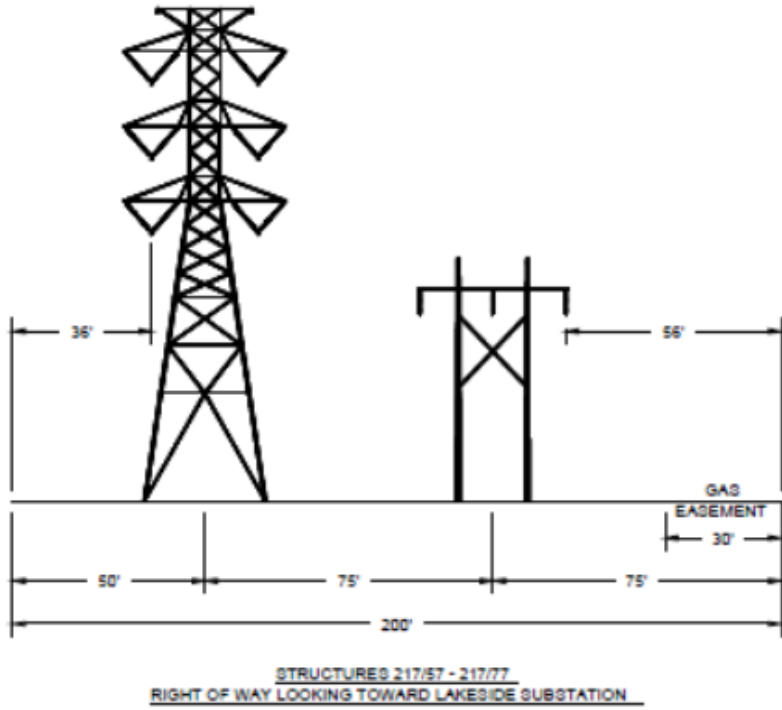

Height range: 56' – 80'

Example of proposed changes

SECTION 9: PROPOSED

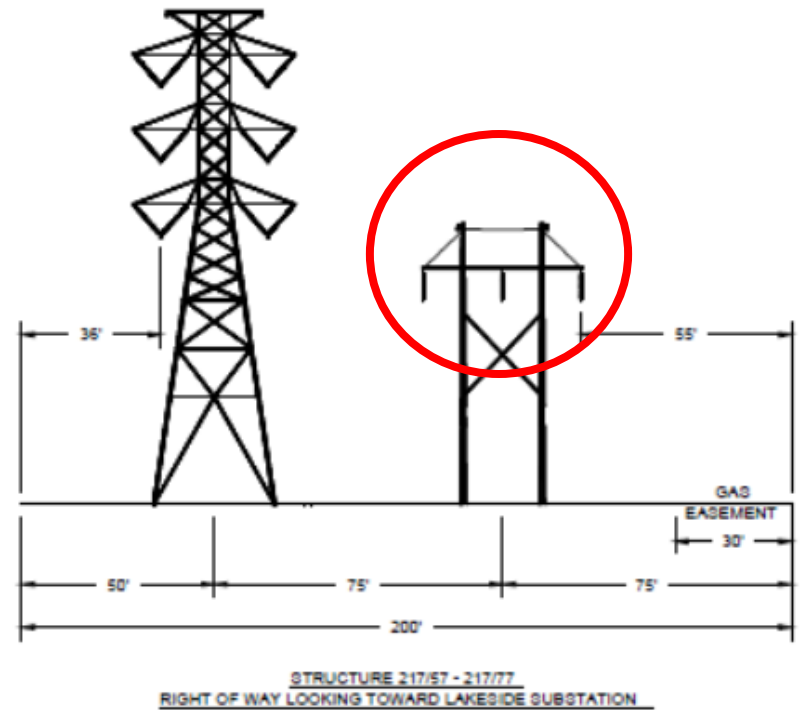

Proposed height range: 60' – 88'

*Subject to final engineering

SECTION 10: EXISTING

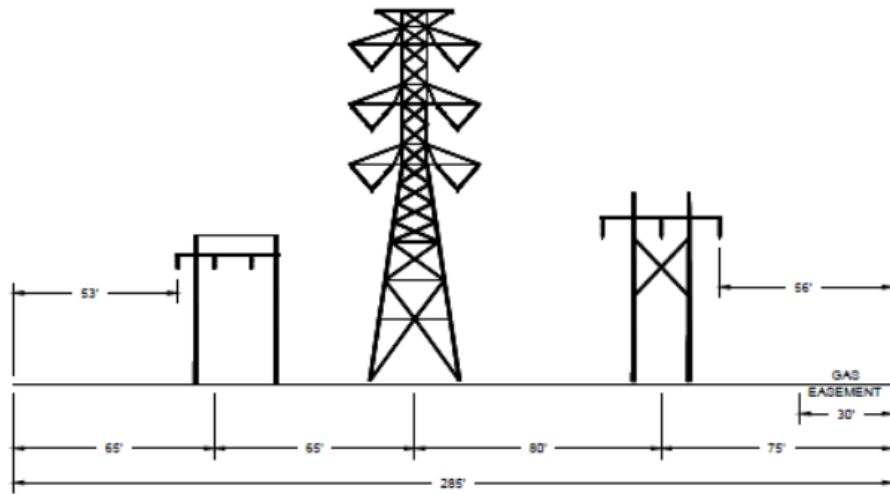

STRUCTURES 217/78 - 217/89
RIGHT OF WAY LOOKING TOWARD LAKESIDE SUBSTATION

Height range: 52' – 75'

Example of proposed changes

SECTION 10: PROPOSED

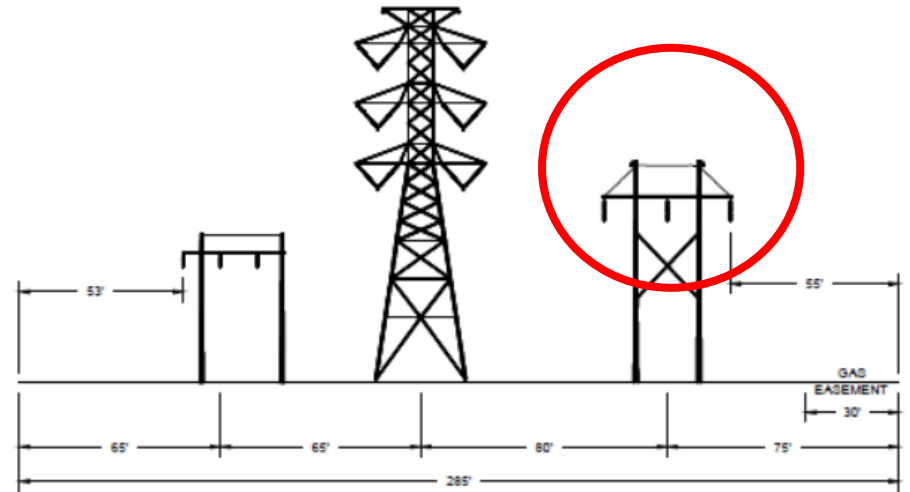

STRUCTURE 217/78 - 217/89
RIGHT OF WAY LOOKING TOWARD LAKESIDE SUBSTATION

Proposed height range: 60' – 84'

*Subject to final engineering

SECTION 15: EXISTING

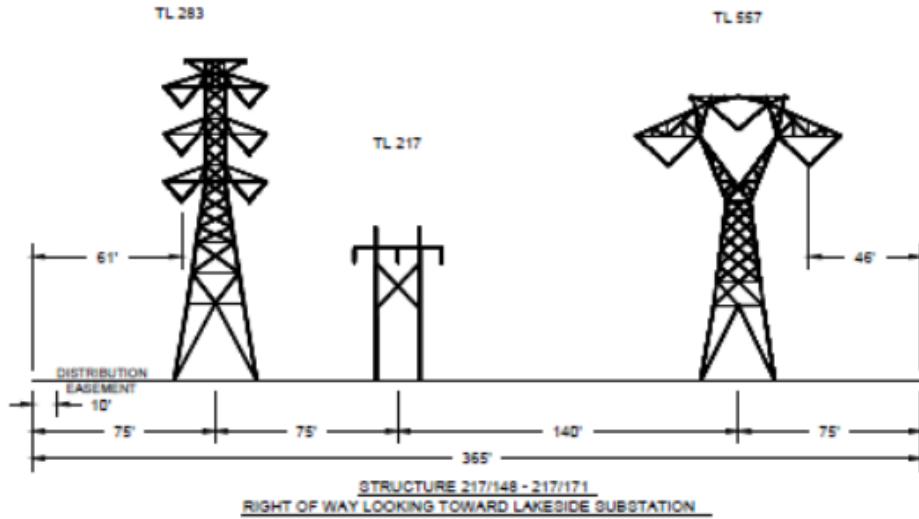

Height range: 55' – 70'

Example of proposed changes

SECTION 15: PROPOSED

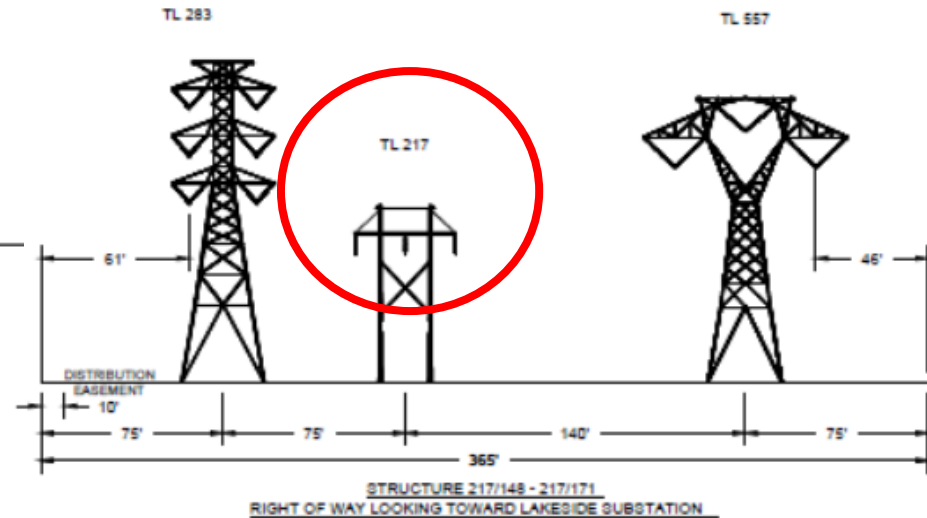

Proposed height range: 60' – 79'

*Subject to final engineering

SECTION 16: EXISTING

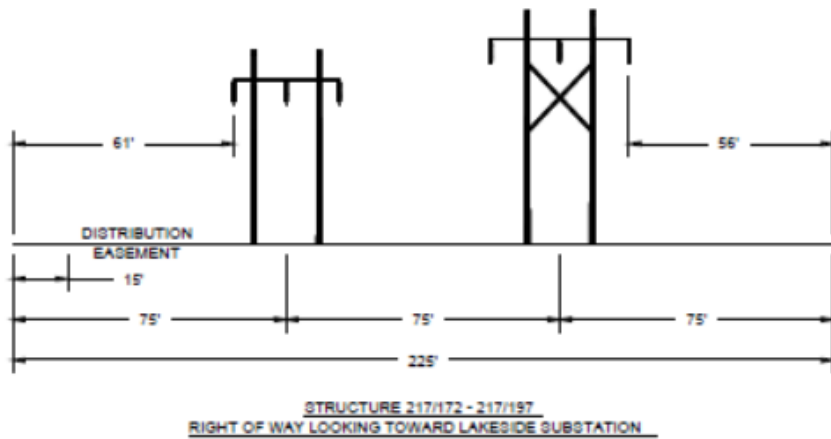

Height range: 52' – 145'

Example of proposed changes

SECTION 16: PROPOSED

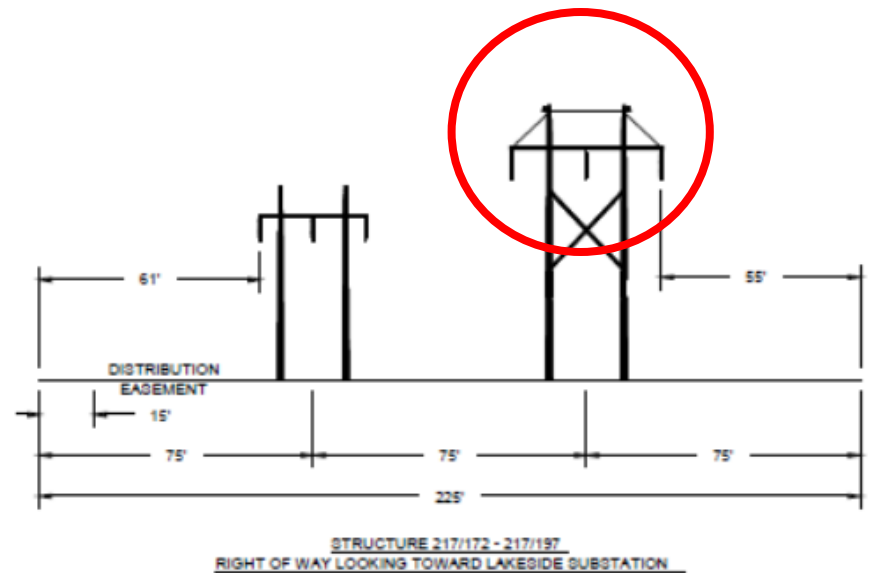

Proposed height range: 55' – 145'

*Subject to final engineering