

# Chesterfield–Lakeside

## *230 kilovolt Transmission Line Rebuild Project*

***April 2018***

# Agenda

---

- Project Need
- Scope of Project
- Community Engagement

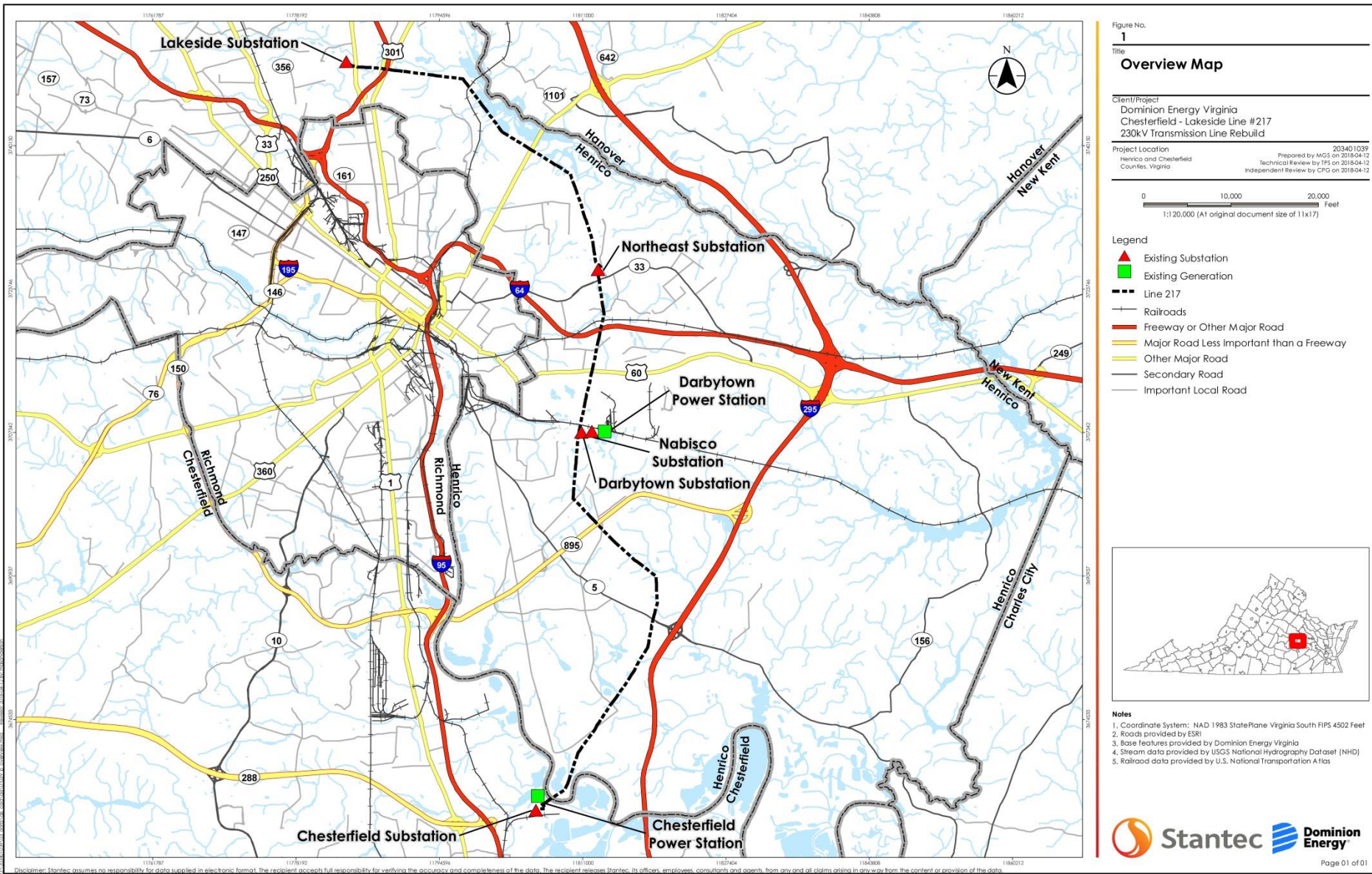

# Reliability Concerns & Drivers

Approximately 21 miles of 230 kV single-circuit line between Chesterfield–Lakeside substations have reached end of service life

*By reconstructing this line, Dominion Energy will also resolve the potential for an identified capacity violation of mandatory North American Electric Reliability Corporation (NERC) reliability standards*

- Structures were installed in the late 1950s
- Static wire is also at end of useful life
- Rebuild to current industry standards
- Targeted in-service date: **June 2020**









# Proposed Solution

In order to maintain structural integrity and reliability, Dominion Energy proposes to rebuild the existing transmission structures/line and replace fiber

- Located entirely within existing right of way
- Largely replacing wood structures with brown, weathering steel structures
  - Galvanized crossarms and cross braces to be installed
- Proposed weathering steel to match replaced and remaining poles
- Partial colocation with another transmission line

## SECTION 2: EXISTING

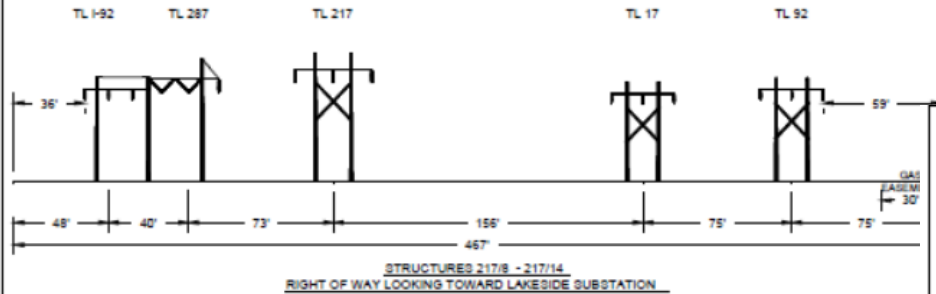

Height range: 57' – 84'

Example of proposed changes

## SECTION 2: PROPOSED

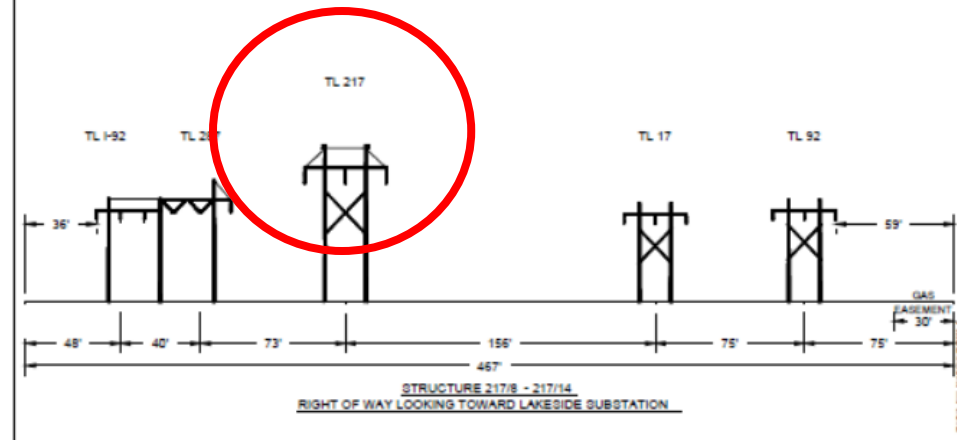

Proposed height range: 75' – 95'

\*Subject to final engineering



SECTION 7: EXISTING

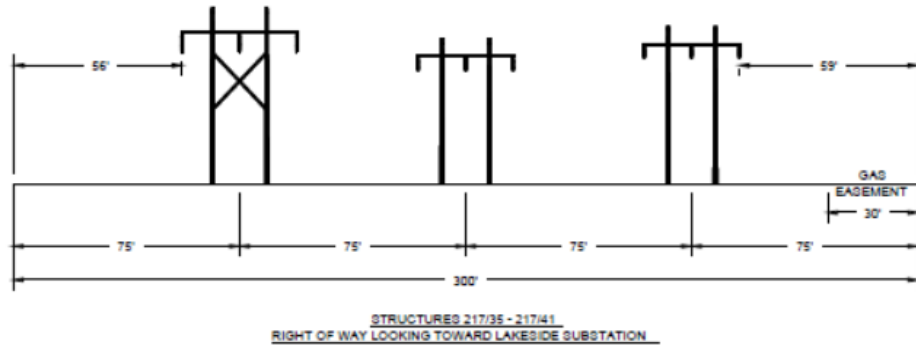

Height range: 52' – 61'

Example of proposed changes

SECTION 7: PROPOSED

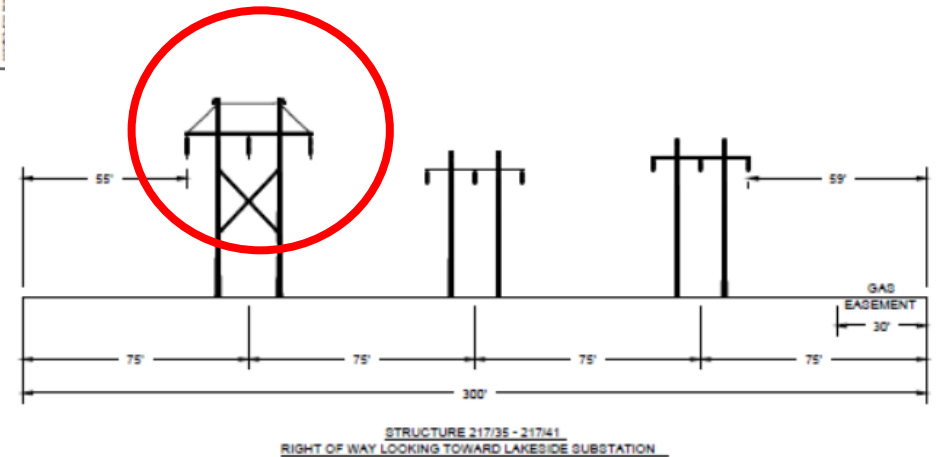

Proposed height range: 60' – 70'

\*Subject to final engineering

## SECTION 9: EXISTING

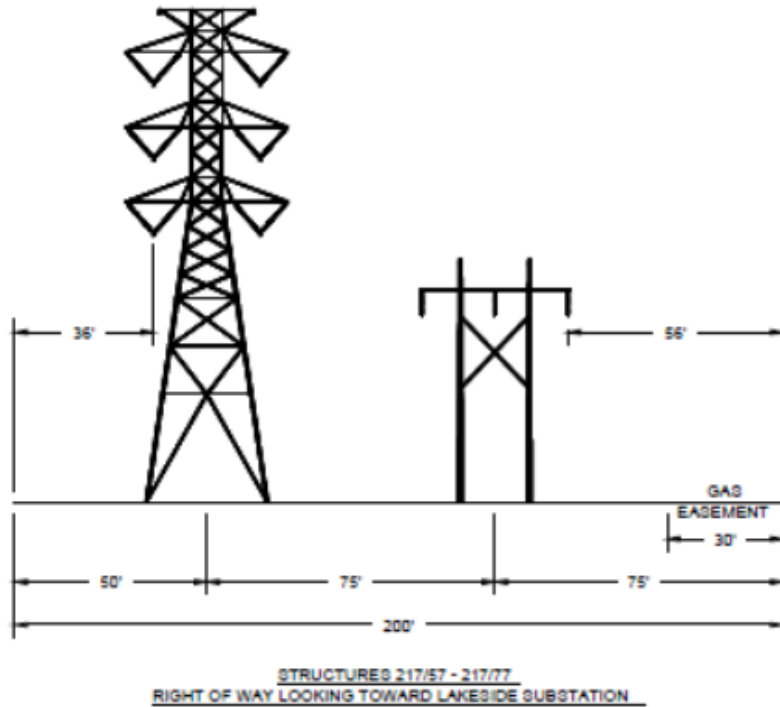

Height range: 56' – 80'

Example of proposed changes

## SECTION 9: PROPOSED

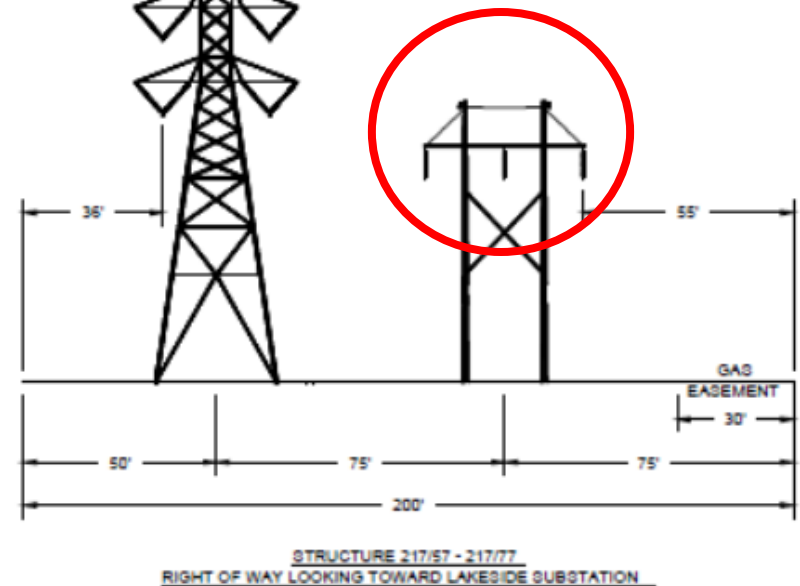

Proposed height range: 60' – 88'

\*Subject to final engineering

SECTION 10: EXISTING

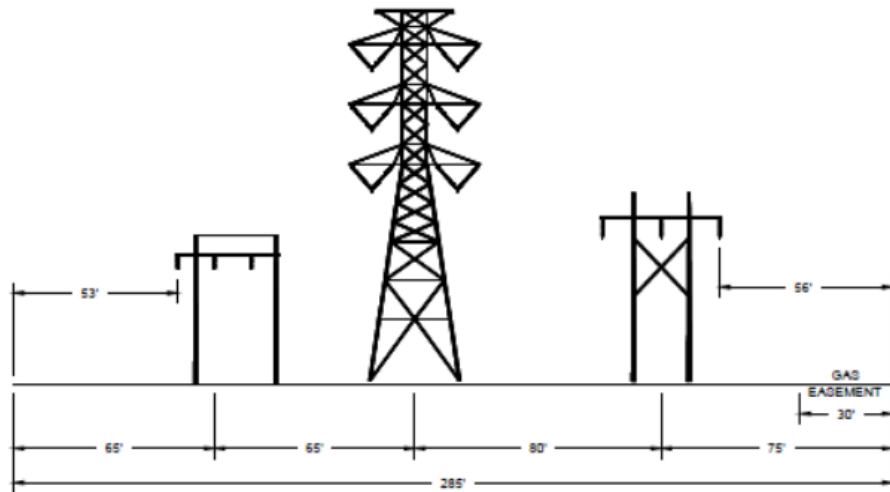

STRUCTURES 217/78 - 217/89  
RIGHT OF WAY LOOKING TOWARD LAKESIDE SUBSTATION

Height range: 52' – 75'

Example of proposed changes

SECTION 10: PROPOSED

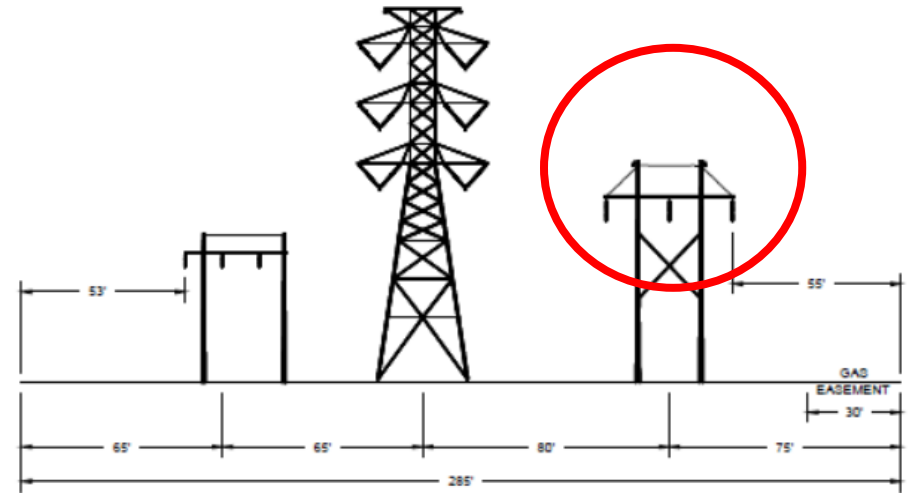

STRUCTURE 217/78 - 217/89  
RIGHT OF WAY LOOKING TOWARD LAKESIDE SUBSTATION

Proposed height range: 60' – 84'

\*Subject to final engineering



Example of proposed changes



Proposed height range: 60' – 79'

12

## SECTION 16: EXISTING

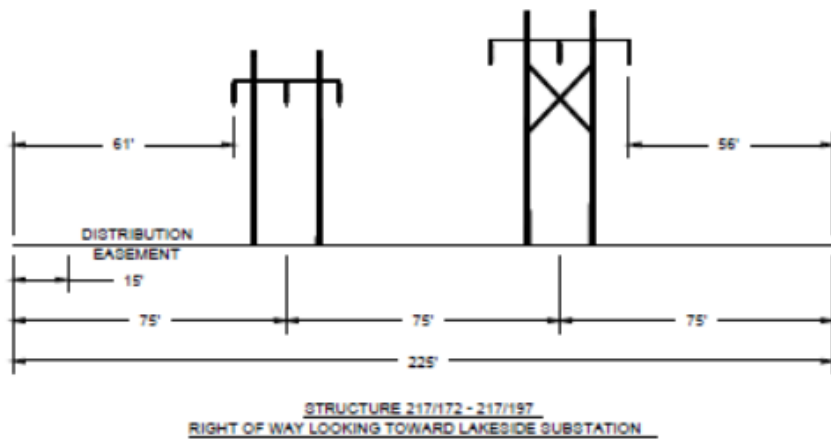

Height range: 52' – 145'

Example of proposed changes

## SECTION 16: PROPOSED

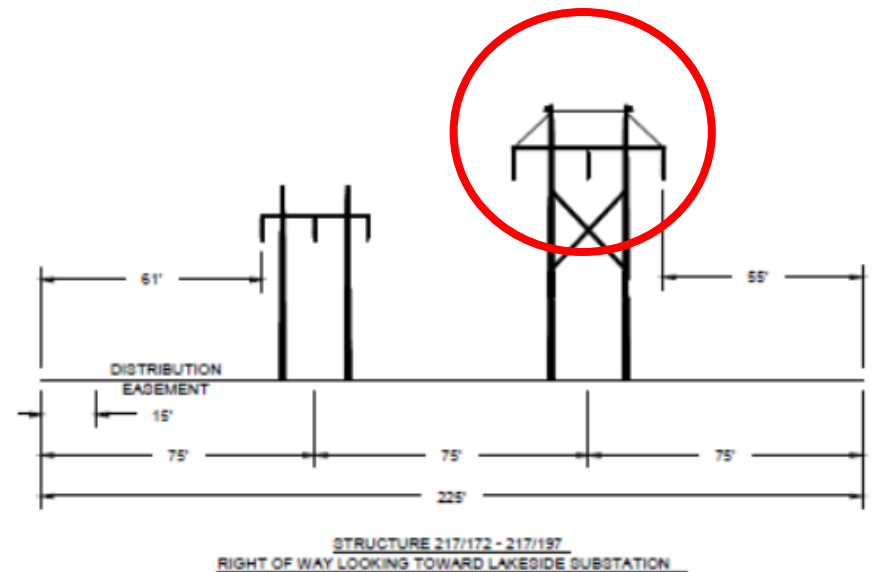

Proposed height range: 55' – 145'

\*Subject to final engineering

# The Transmission Line Approval Process

Virginia's State Corporation Commission (SCC) has regulatory authority over all electric utilities and requires that all transmission facilities at or above 138 kV be certified by the SCC.

The SCC determines the need for a proposed line and the route. Among other elements considered, the SCC must determine that the selected route reasonably minimizes the impact on scenic assets, historic districts, and the environment.

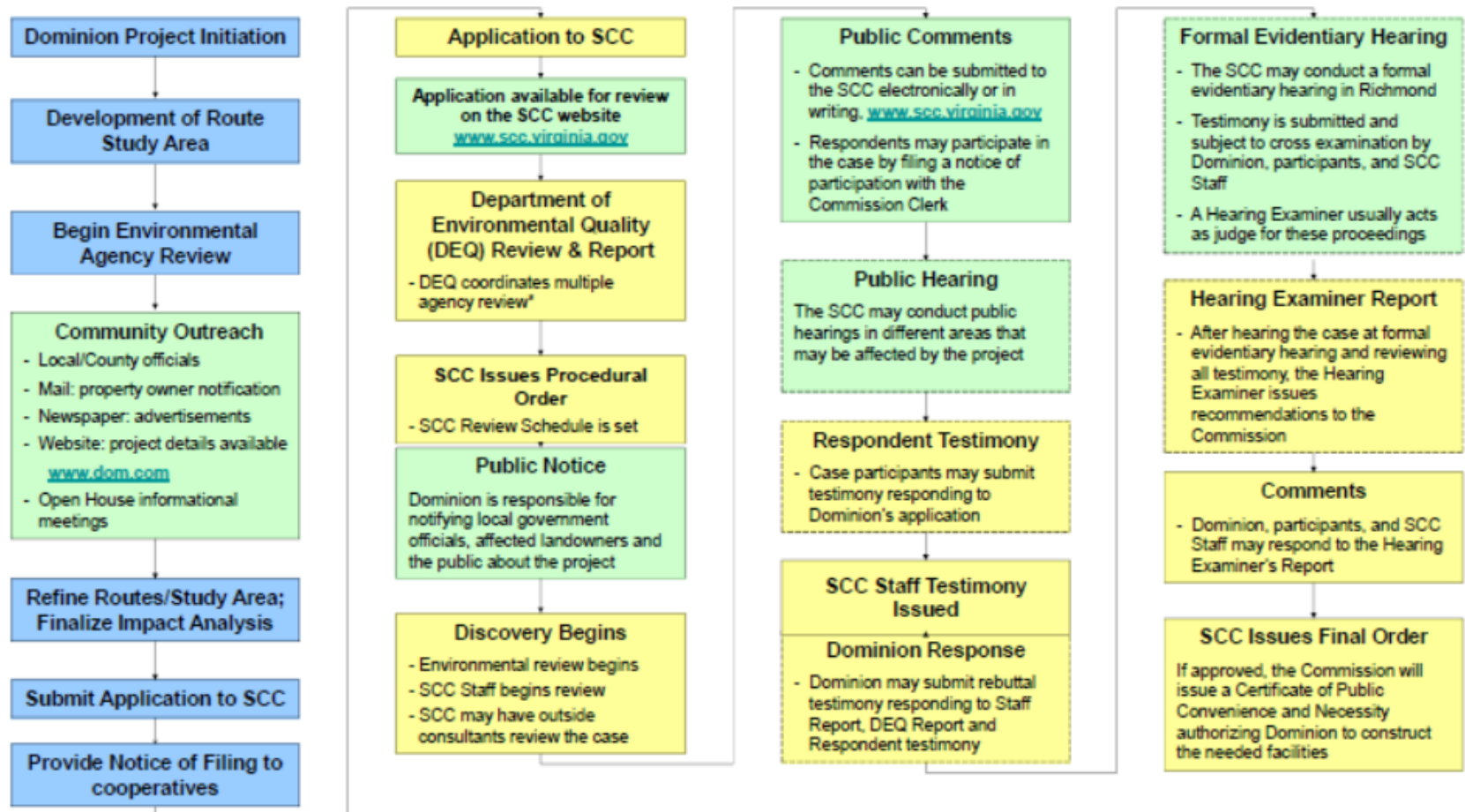

\*DEQ coordinated agency review includes: Virginia Marine Resources Commission, Department of Conservation & Recreation, Department of Game & Inland Fisheries, Department of Historic Resources and others.

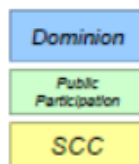

SCC Approval Process Time May Vary

**How to comment to the SCC:** Public comments related to Commission cases are accepted for a limited time. Cases for which comments are currently being accepted by the SCC are listed in the Public Comments/Notices page.  
<http://www.scc.virginia.gov/case/publicComments.aspx>

This is a conceptual diagram to illustrate the certification process and is not intended to be a legal description.



# Public Safety & Access

- Unauthorized Encroachments
  - Primarily sheds
- Mitigation Plan
  - Focus on encroachments in the area of the rebuild project
  - Identify and address safety concerns over the entire right of way
  - Customary approach to fences in the right of way
  - Remove trees near right of way that create safety and reliability challenges
    - Grassroots education on safety and clearing within the community

# Next Steps

- April 2018                      Meet with local elected officials  
Project website launched; Dedicated email/phone open
- May 8 & 9, 2018              Host two public open houses
- Late-May 2018                File application with VA State Corp. Commission (SCC)
- Q3-Q4 2018                    Procedural order issued, public hearing scheduled
- ~Q1 2019                        Requested date for SCC approval
- June 2020                        Projected in-service date

# Questions

**Dedicated Project Page:**  
**[www.DominionEnergy.com/ChesterfieldLakeside](http://www.DominionEnergy.com/ChesterfieldLakeside)**

**888-291-0190**  
**[powerline@dominionenergy.com](mailto:powerline@dominionenergy.com)**