

DIRECTIONS FOR IN-PROCESSING OR TRAINING

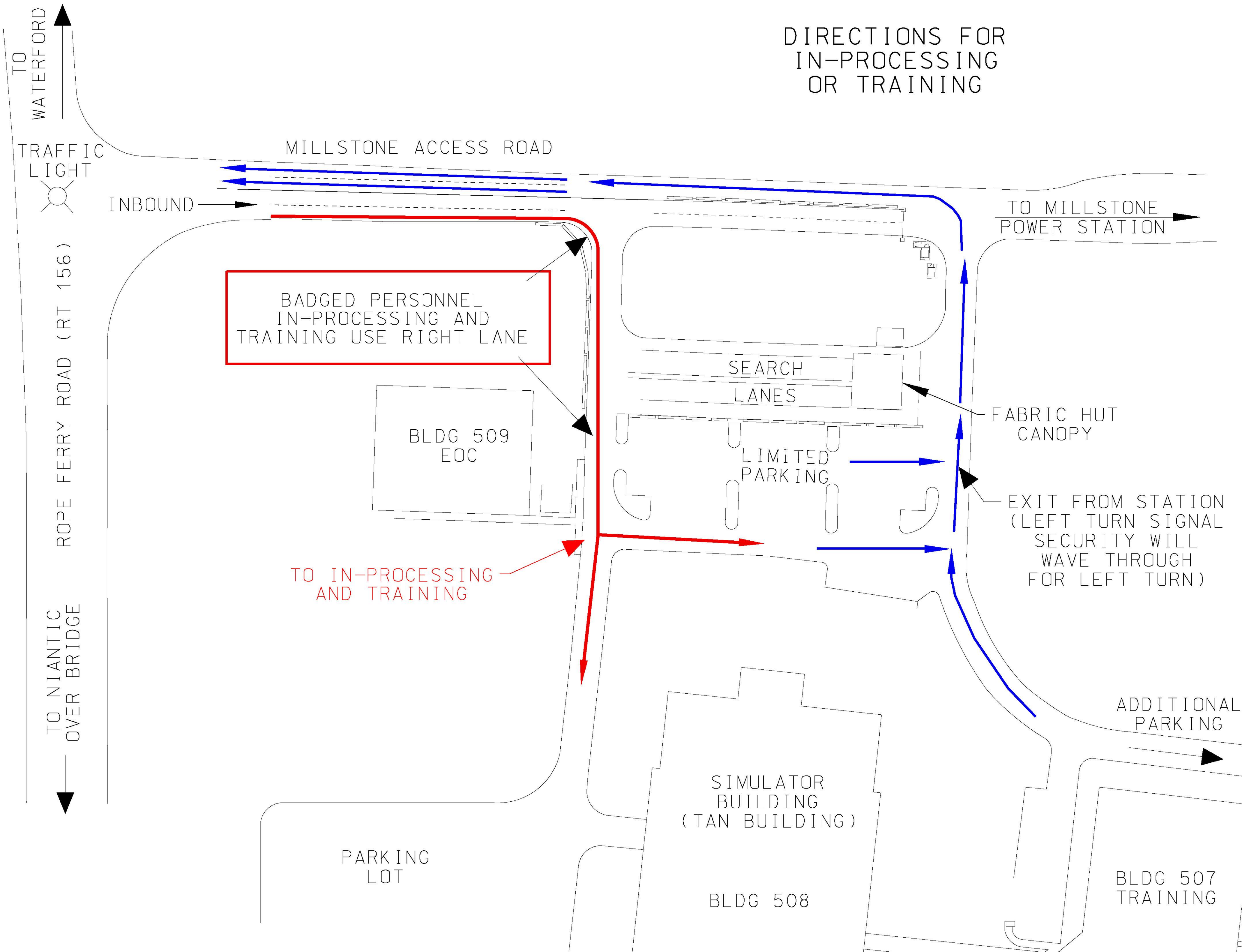

TO WATERFORD

TRAFFIC LIGHT

ROPE FERRY ROAD (RT 156)

TO NIANTIC OVER BRIDGE

MILLSTONE ACCESS ROAD

INBOUND

BADGED PERSONNEL
IN-PROCESSING AND
TRAINING USE RIGHT LANE

BLDG 509
EOC

SEARCH
LANES

LIMITED
PARKING

TO IN-PROCESSING
AND TRAINING

TO MILLSTONE
POWER STATION

FABRIC HUT
CANOPY

EXIT FROM STATION
(LEFT TURN SIGNAL
SECURITY WILL
WAVE THROUGH
FOR LEFT TURN)

ADDITIONAL
PARKING

SIMULATOR
BUILDING
(TAN BUILDING)

PARKING
LOT

BLDG 508

BLDG 507
TRAINING